

Disclaimer: This plan is for marketing purposes only, is not to scale, and will not form part of any contract for the sale of the property. The plan was produced prior to construction, and any dimensions, areas, fittings, finishes and specifications referred to in the plan are subject to change without notice. The sale of the property will exclude any furniture and furnishings depicted in the plan, and the positioning of any furniture and furnishings in the plan cannot be relied upon as an indication of the final positioning of any powers points, TV connection points and the like. For details of the inclusions in the sale, prospective buyers should refer to the Schedule of Finishes and other provisions expressly stated in the contract for sale. All graphics, including but not limited to tile layout and balustrades, are indicative only. Bulkheads for services are not depicted.

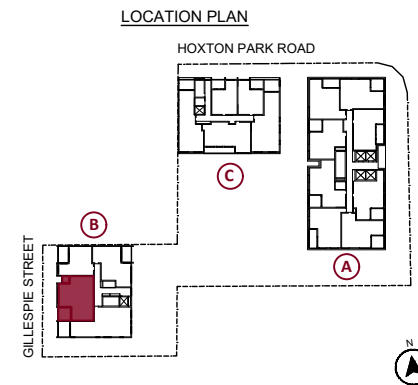

THE HOXTON

LIVERPOOL

N.6 GILLESPIE STREET

**BUILDING B
UNIT 6.02**

PT 270



AREA

| | | |
|----------------|-----|----------------|
| INTERNAL AREA: | 93 | m ² |
| EXTERNAL AREA: | 12 | m ² |
| TOTAL AREA: | 105 | m ² |

MARKETING FLOOR PLAN

REV: A

